

CABINET

17 April 2018

PARKING REVIEW

REPORT OF THE DIRECTOR FOR PLACES (ENVIRONMENT, PLANNING & TRANSPORT)

Strategic Aim:	Sustainable Growth	
Key Decision: Yes	Forward Plan Reference: FP/061217	
Exempt Information	No	
Cabinet Member(s) Responsible:	Mr N Begy, Deputy Leader and Portfolio Holder for Planning Policy and Planning Operational, Highways & Transportation, Communications	
Contact Officer(s):	Dave Brown, Director for Places (Environment, Planning & Transport)	01572 758461 dbrown@rutland.gov.uk
	James von der Voelsungen, Parking Services Manager	01572 722577 jvondervoelsungen@rutland.gov.uk
Ward Councillors	Not applicable	

DECISION RECOMMENDATIONS

That Cabinet:

- 1 Approves the recommended amendments and additions to parking restrictions listed in Appendix 1 and 2 and delegates the consideration of any objections to the statutory consultation for the Traffic Regulation Orders (TROs) to the Director for Places (Environment, Planning & Transport) in consultation with the Ward Members and Portfolio Holder, along with the authority to modify the proposed TROs.
- 2 Approve a 6 month trial of 2 hour free parking at Catmose on Saturdays.

1 PURPOSE OF THE REPORT

- 1.1 To consider amendments and additions to parking restrictions.

2 BACKGROUND AND MAIN CONSIDERATIONS (MANDATORY)

- 2.1 The Strategic Parking Review was approved in March 2012. The objective of the review was to devise a set of parking policies and principles that would set the basis of future parking reviews. Each year a list of requests for parking restrictions from our stakeholders (usually residents, businesses and parish councils) are presented for consideration by Cabinet. A deadline for requests for changes/additions to parking restrictions has been set as 31st August each year. The public requests for changes are detailed in Appendix 1, and officer requests are detailed in Appendix 2.
- 2.2 At present there is a temporary arrangement whereby motorists can park free for one hour all week in Church St car park and on Saturdays in the Catmose car park. This was put in place during the town centre roadworks. To attract more visitors into Oakham and make more use of the Catmose car park on Saturdays it is recommended that this is continued in the Catmose car park but for 2 hours on a trial basis. As there is little use of this car park on Saturdays the predicted effect on income would depend on how much parking is displaced from other car parks. The proposal will be for a trial period of 6 months while the impact on income is determined.
- 2.3 The introduction of Limited Waiting in Oakham Resident Bays has been considered previously by Cabinet and the decision was to keep this under review. Spot checks in Autumn 2017 confirm that there is still an opportunity to optimise the use of on street parking space in Oakham resident's bays during weekday daytimes. Oakham resident bays are generally restricted Monday-Saturdays 8am-8pm. Having limited waiting in the resident bays would allow residents visitors to park without the need for visitor permits, and also give general motorists the opportunity to park to visit the town centre. This is not recommended at this time and will continue to be reviewed on an annual basis.

3 CONSULTATION

- 3.1 Informal consultation with parish/town councils and Ward Members has taken place regarding the restrictions in Appendix 1 & 2. Further informal consultation may be necessary.
- 3.2 Statutory consultation involving press notices and notices posted in the relevant areas is required prior to making the Traffic Regulation Orders (TROs).

4 ALTERNATIVE OPTIONS

- 4.1 All the proposed restrictions in Appendix 1 that are recommended for approval are in accordance with parking policies. Cabinet could choose to approve proposals that are not in accordance with the policies or to reject any of the proposals.

5 FINANCIAL IMPLICATIONS

- 5.1 The cost of the implementing the recommended changes in Appendices 1 and 2 will be met from the existing budget. Enforcement in new areas will be contained

within existing resources by adjusting enforcement schedules. The financial impact of free 2 hours parking at Catmose on Saturdays is difficult to predict and will be determined during a 6 month trial.

6 LEGAL AND GOVERNANCE CONSIDERATIONS

- 6.1 Traffic regulation orders (TROs) will be required to implement the recommended changes. This will require statutory consultation. There is a significant lead in time to changing TROs due to the consultation and legal processes involved.

7 EQUALITY IMPACT ASSESSMENT

- 7.1 Equality Impact Assessment screening has been undertaken and there are no adverse effects due to this policy.
- 7.2 Rutland Access Group is consulted as part of the informal and statutory consultation process.

8 COMMUNITY SAFETY IMPLICATIONS

- 8.1 There are no community safety implications arising from this report.

9 HEALTH AND WELLBEING IMPLICATIONS

- 9.1 There are no health and wellbeing implications arising from this report.

10 CONCLUSION AND SUMMARY OF REASONS FOR THE RECOMMENDATIONS

- 10.1 The recommended amendments and additions to parking restrictions will help ensure, so far as is reasonably practicable, the safe and expeditious movement of traffic while providing adequate parking to support the local economy and the needs of residents.

11 BACKGROUND PAPERS

- 11.1 Strategic Parking Review (Parking Strategy)
http://www.rutland.gov.uk/transport_and_streets/parking/parking_strategy.aspx

12 APPENDICES

- 12.1 Appendix 1 Public Requests for Restrictions
- 12.2 Appendix 2 Officer Requests for Changes to Restrictions
- 12.3 Appendix 3 Maps

A Large Print or Braille Version of this Report is available upon request – Contact 01572 722577.

Appendix 1: Public Requests

Town / Village	Street	Location	Request Summary	Parish or Town Council Support Y/N	Ward Member Support Y/N	In Accordance with Policy Y/N	Policy Ref	Recommended Y/N	Officer Comments
Oakham	Park Lane	west end	Double yellow lines	Y	1 of 2, pending other	Y	PP5	Y	
Oakham	Brooke Road	between zigzags and Trent Road, both sides	(Double) Yellow lines	Y	YY	Y	PP10	Y	
Oakham	Northgate	all residents bays	Allow D permits on Northgate	Y	YY	Y	PP18	Y	In practice already due to roadworks.
Oakham	Kilburn End	by play area	Double yellow lines	Y	Y	N	PP8	N	
Oakham	Derwent Drive	both sides from bridge over brook to Braunston Road	Residents and limited waiting bays and yellow lines	Y	YY	Y	PP5	Y	
Uppingham	South View	south kerb, east of graveyard	Replace access bar with double yellow lines and extend bay westwards by 1 car length	Y	YYY	Y	PP5	Y	Needed due to access to development
Greetham	Main Street	outside shop	Limited waiting bay	Y	Y	N	PP8	N	
Hambleton	Ketton Road	south kerb outside 1-3 Post Office Cottages	Residents bay	Y	Y	N	PP18	N	
Whissendine	Main Street	outside shop	Limited waiting bay	Y	Y	N	PP8	N	

Appendix 2: Officer Requests

Town / Village	Street / car park	Location	Request Summary	Ward	Town Council Support Y/N	Ward Member Support Y/N	In Accordance with Policy Y/N	Policy Ref	Recommended Y/N	Comments
Oakham	Catmose Street	West side outside Rutland Sports / Tonnerre	Replace Double Yellow Lines with limited waiting bay	SE	Y	Y	Y	PP1 PP5	Y	
Oakham	Catmose Car Park	Pay & Display bays	6 month trial of 2 hour free parking on Saturday	SE	Y	Y	Y	PP14	Y	Temporary arrangement is 1 hour free on Saturdays. Recommend this is continued.
Oakham / Barleythorpe	Hackamore Way	From Lands End Way westwards to cover Old Buttercross pub junction	Double yellow lines to prevent HGV parking	NW	incl. Parish, pending	pending	Not covered	NA	Y	Not covered by existing policies, but recommended to reduce adjacent environmental impacts from lorry drivers

Appendix 3 - Maps

Park Lane, Oakham

No waiting at any time

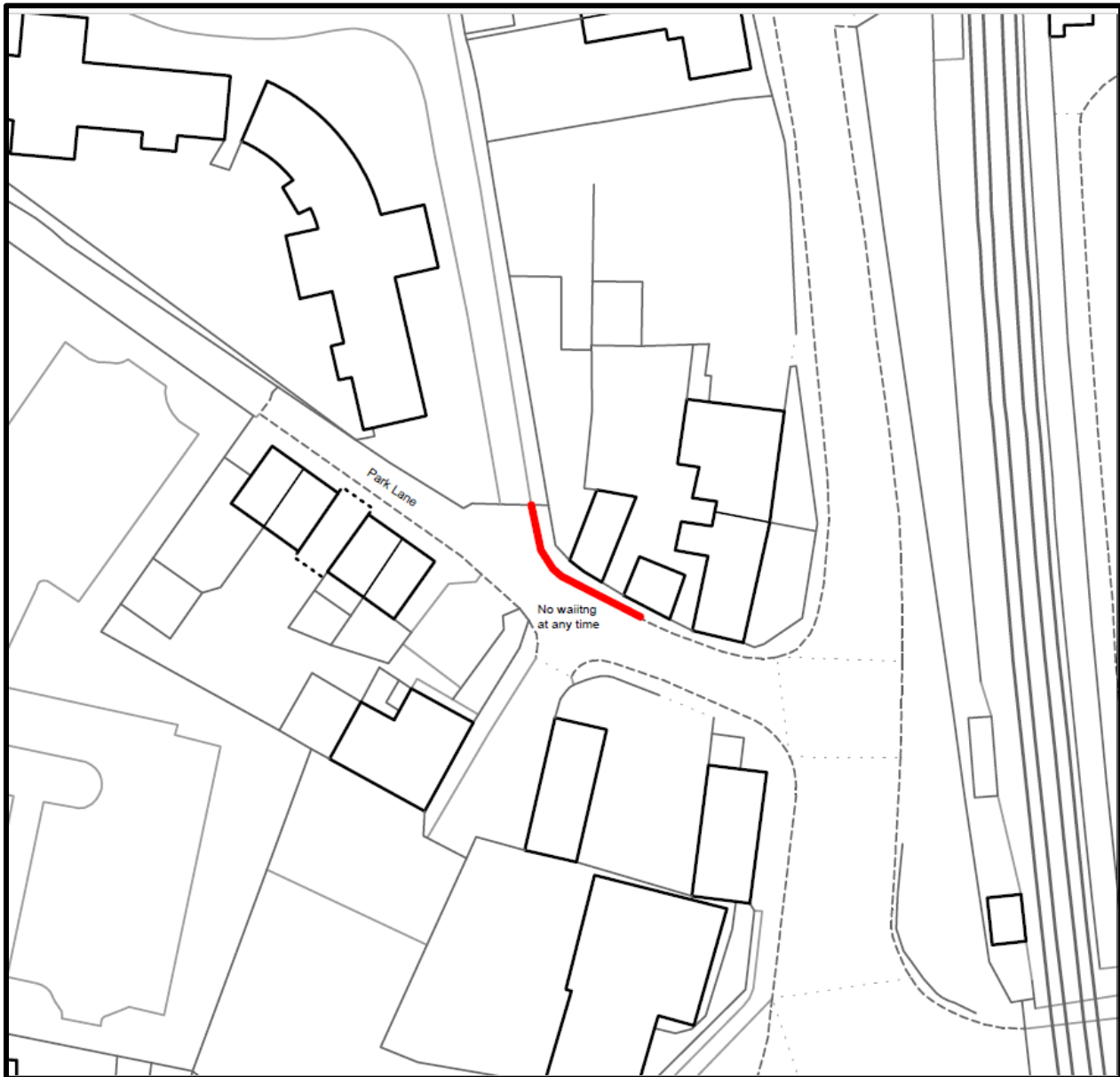

Appendix 3 - Maps

Brooke Road, Oakham

No waiting at any time

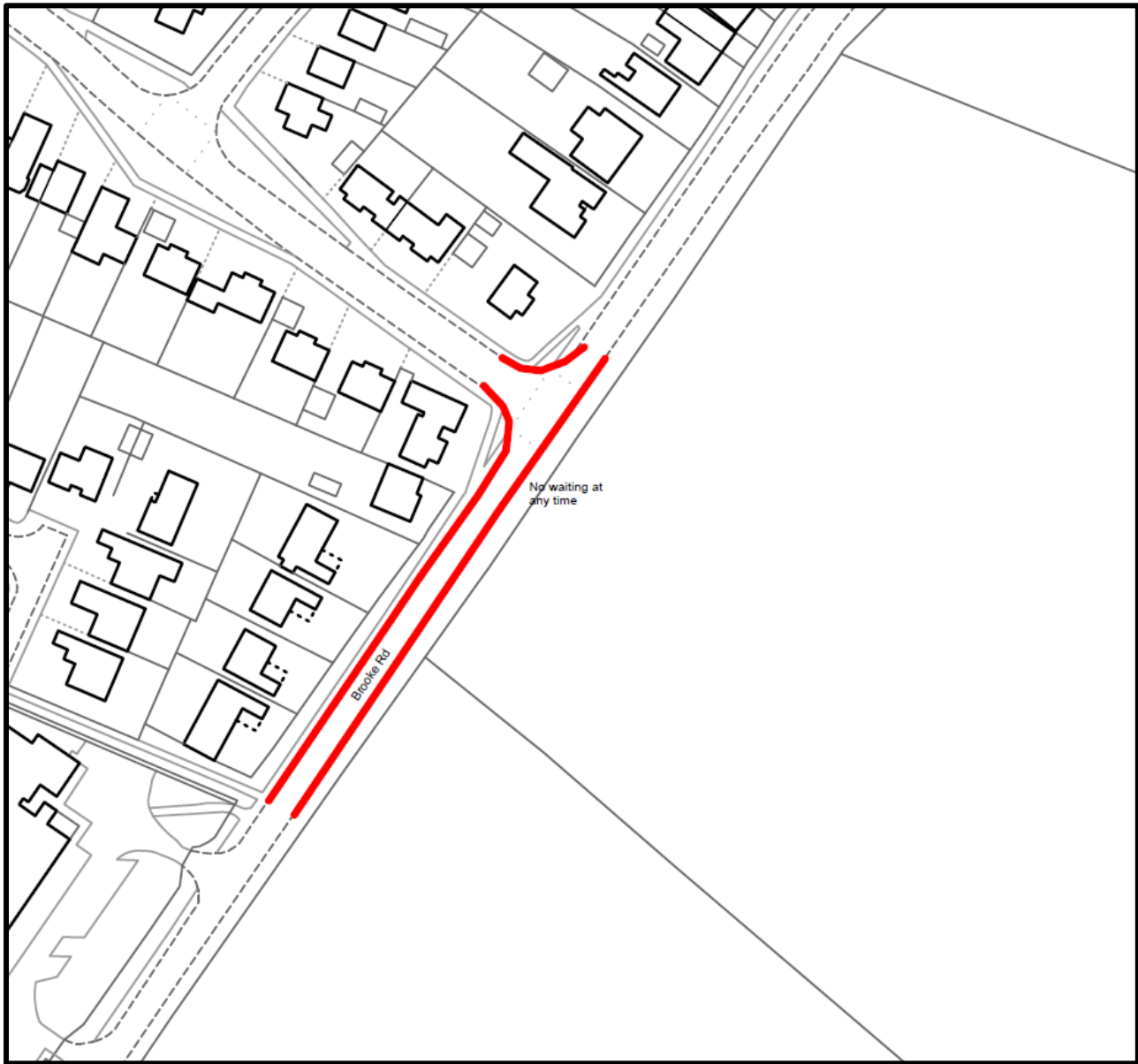

Appendix 3 - Maps

Kilburn End outside playground, Oakham

No waiting at any time

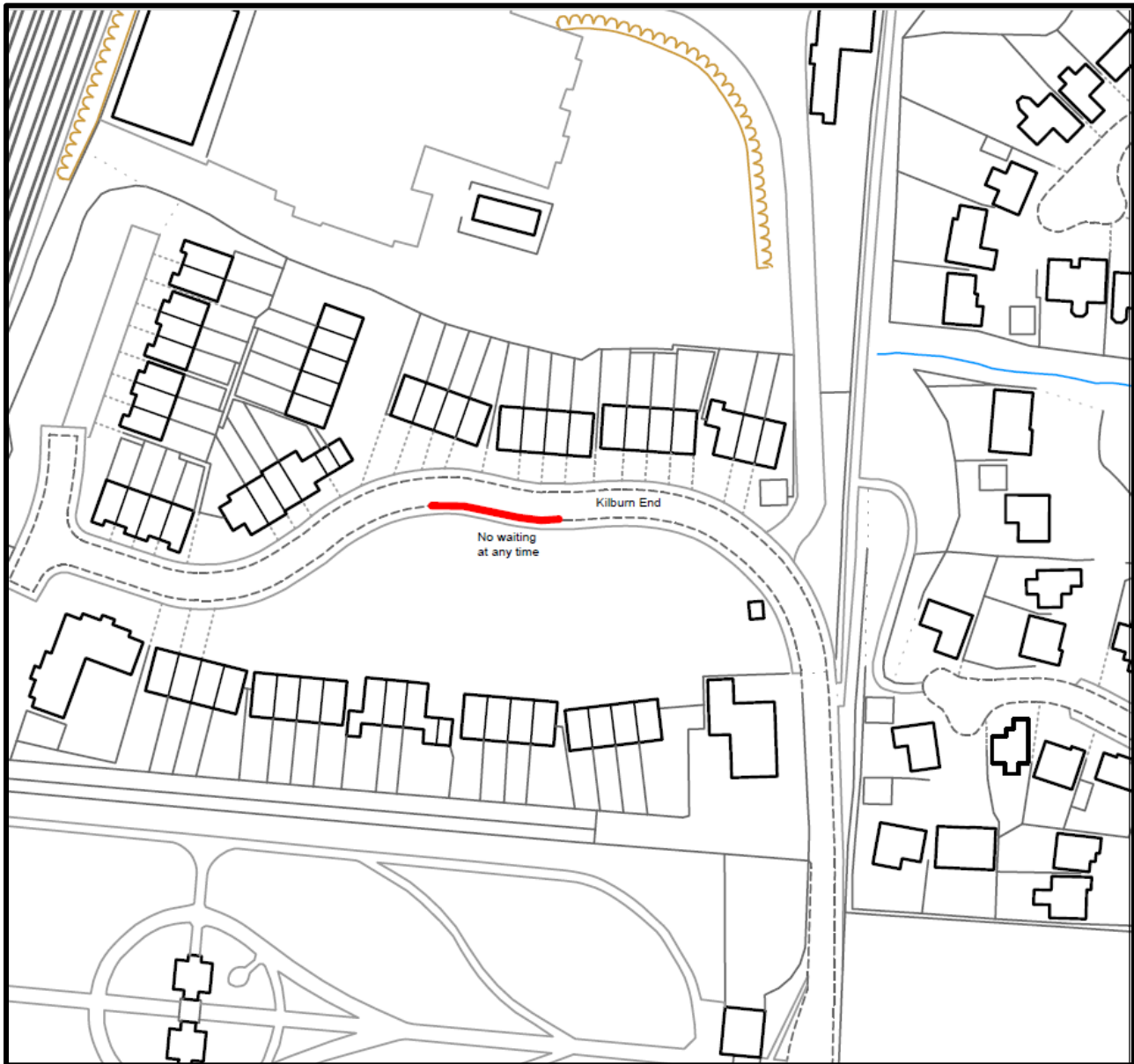

Appendix 3 - Maps

Derwent Drive north section, Oakham

No waiting restriction

Resident / limited waiting bays

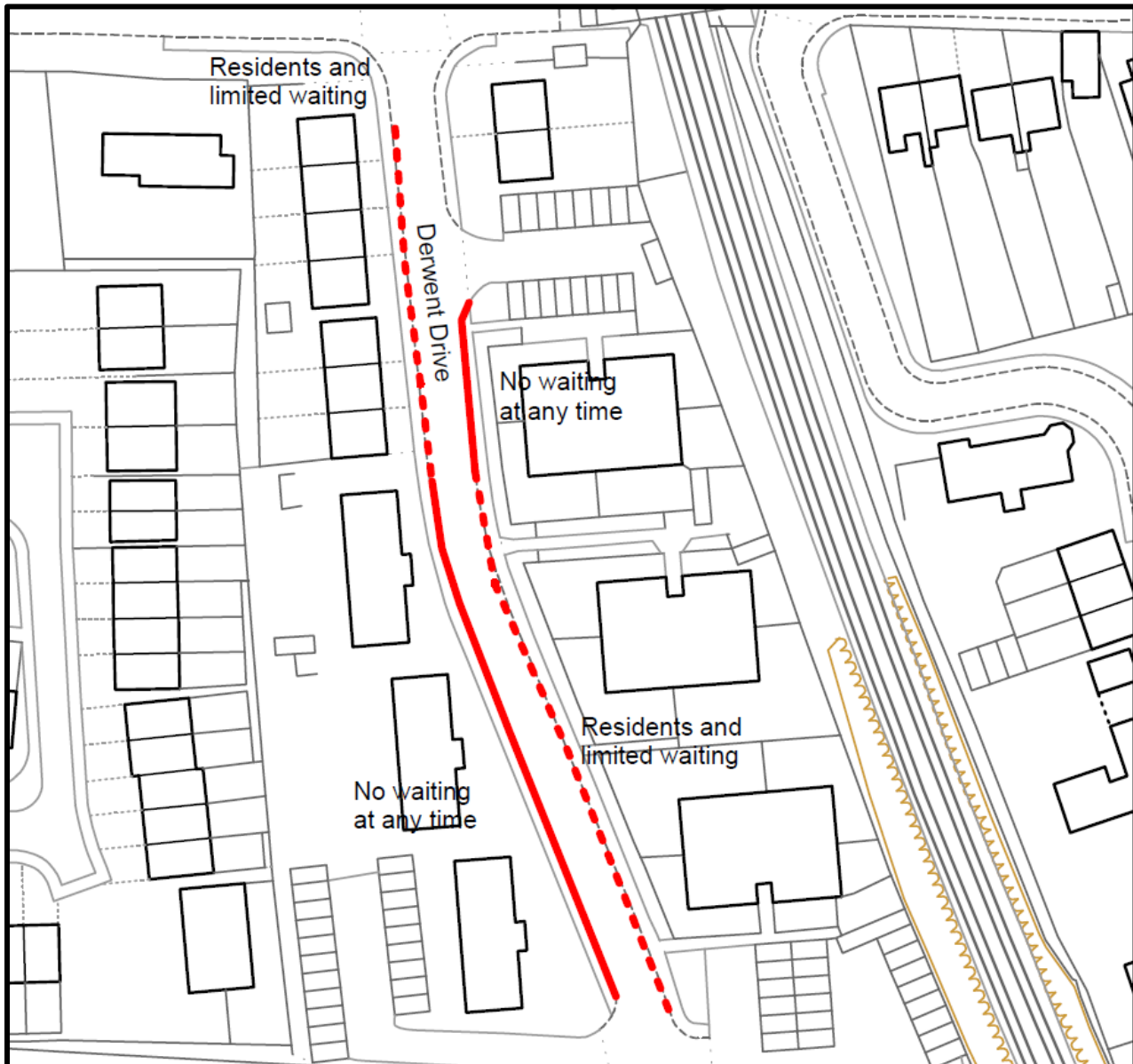

Appendix 3 - Maps

South View, Uppingham

Resident / limited waiting bay change

No waiting at any time

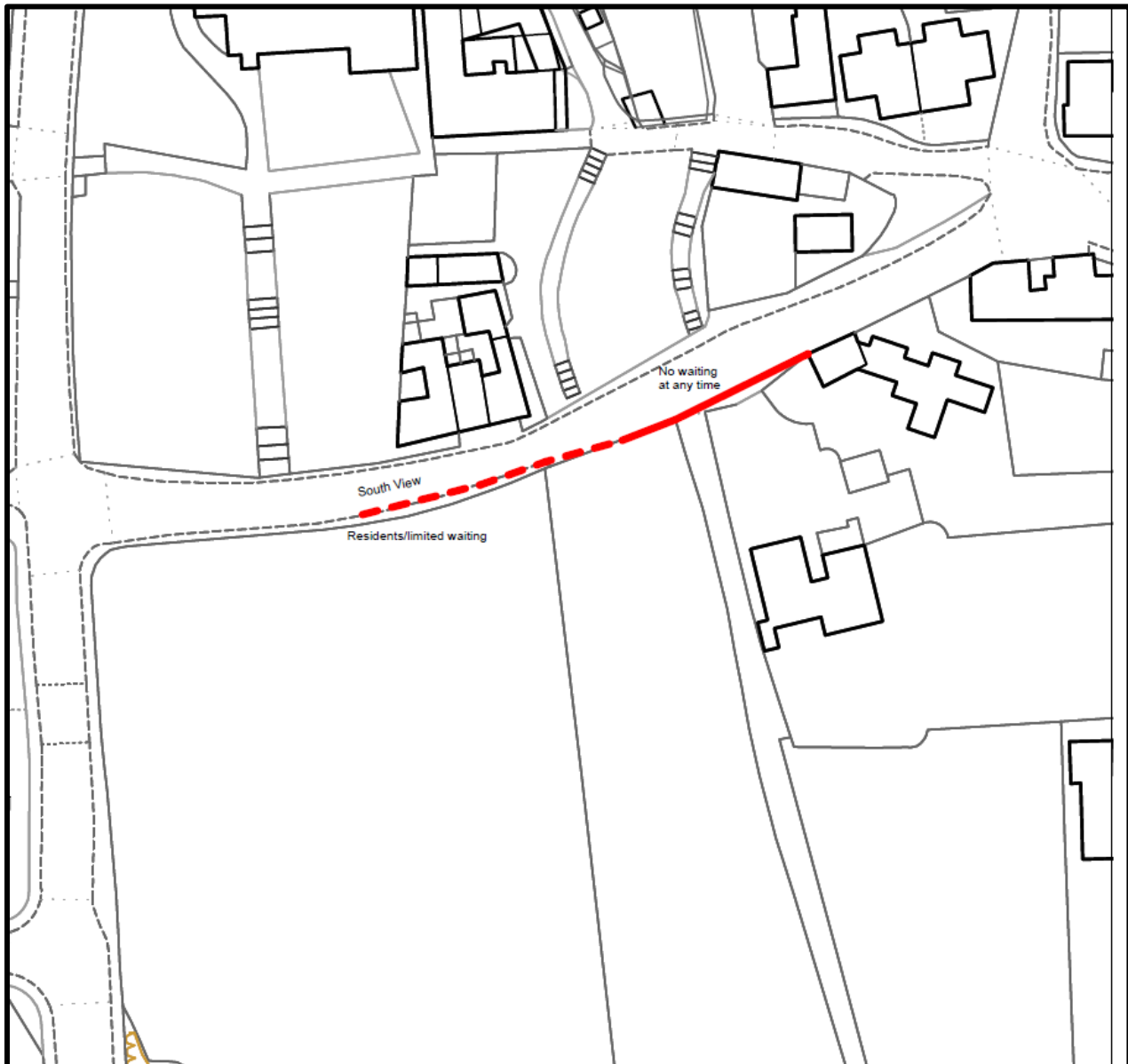

Appendix 3 - Maps

Main Street outside shop, Greetham

Limited waiting bay

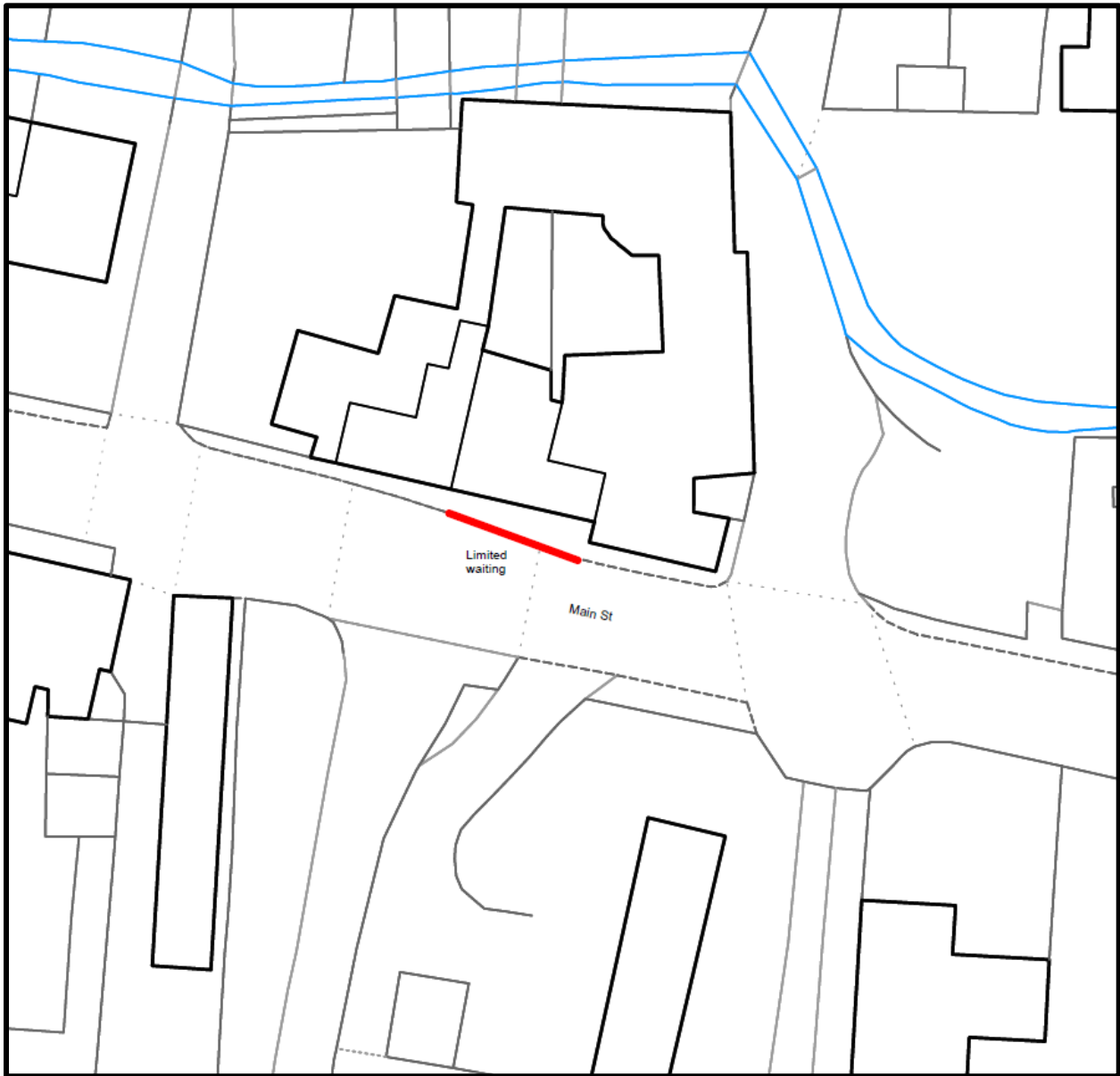

Appendix 3 - Maps

Ketton Road outside Post Office Cottages, Hambleton

Resident bay

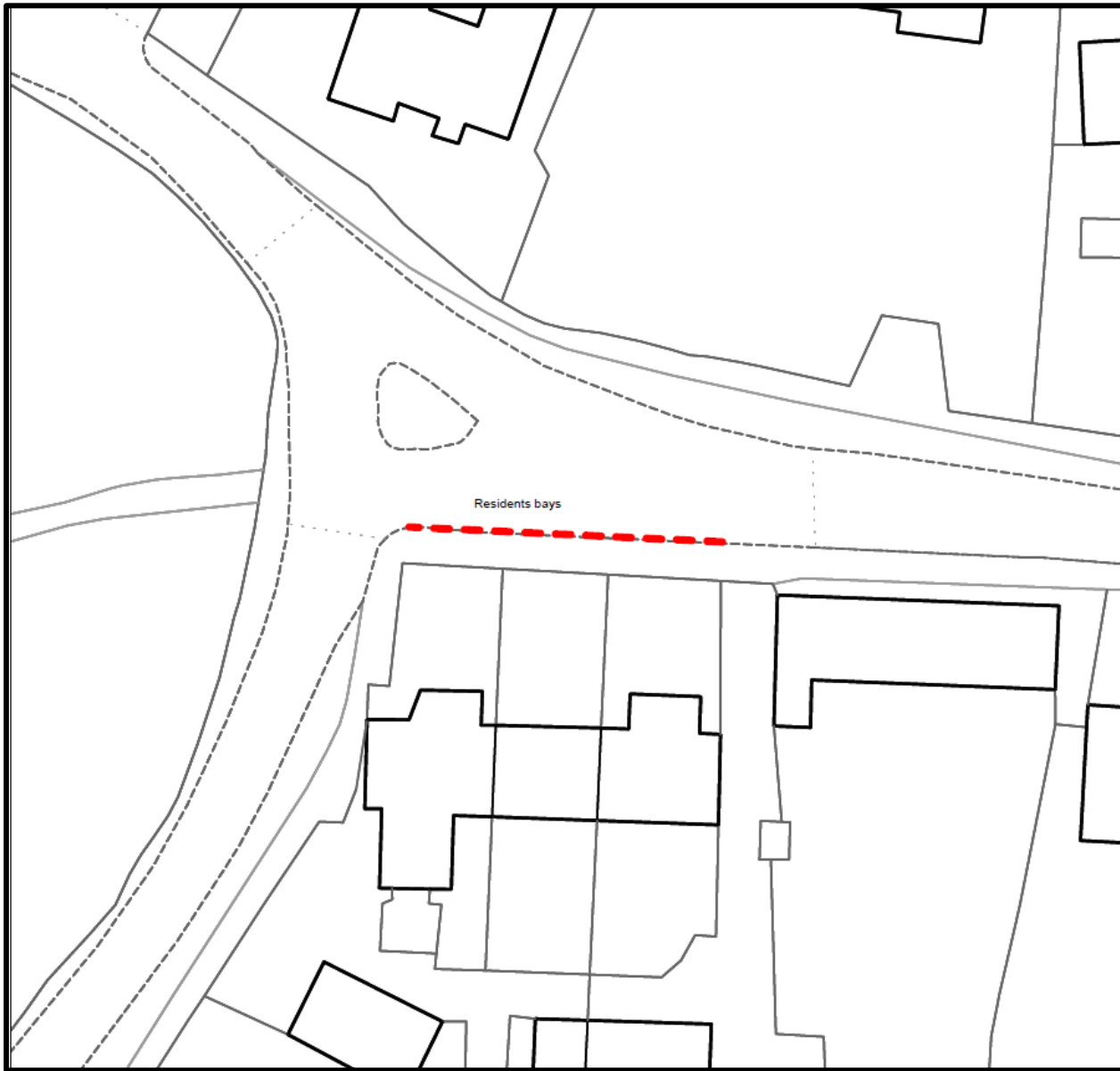

Appendix 3 - Maps

Main Street outside shop, Whissendine

Limited waiting bay

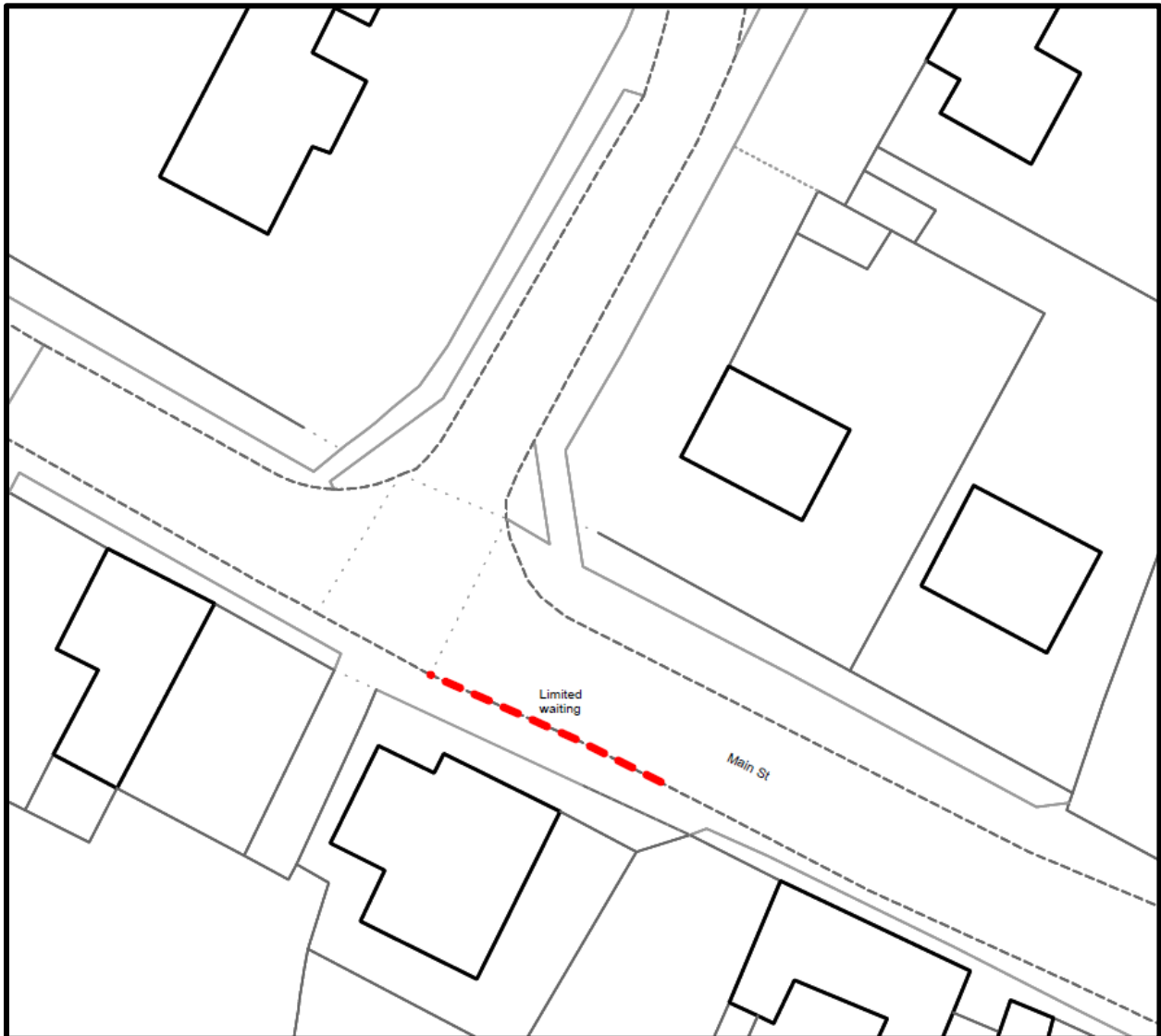

Appendix 3 - Maps

Catmose Street outside shops, Oakham

Limited waiting bay

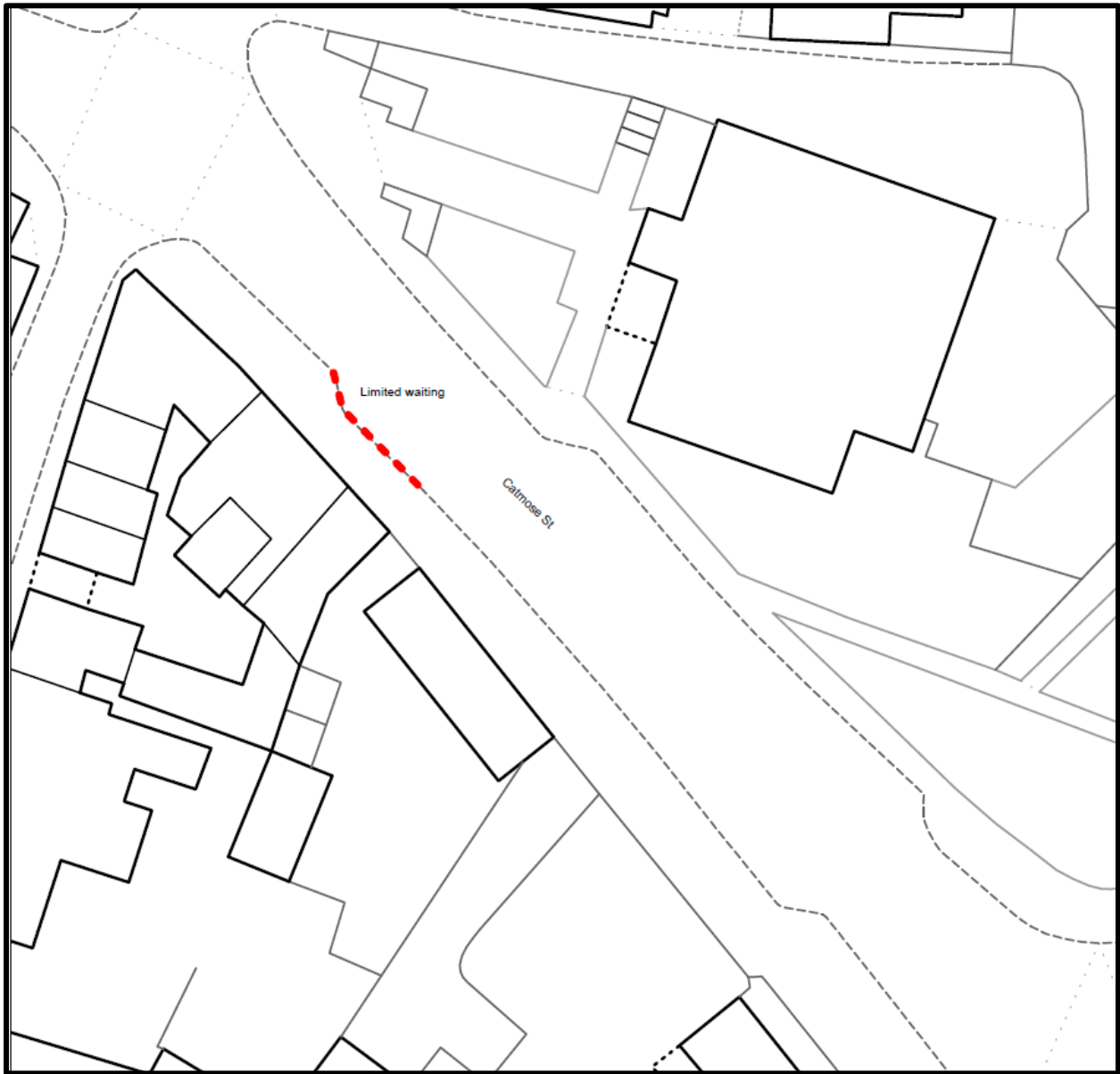

Appendix 3 - Maps

Hackamore Way, Oakham/Barleythorpe

No waiting at any time

